



**AGRIA HISPANIA, S.A.**

# **MOTOAZADA Serie 601**



**MOTOAZADAS  
MOTORHOES  
MOTONINEUSES**

**700 / 5**

**CATALOGO DE PIEZAS DE RECAMBIO  
SPARE PARTS CATALOGUE  
CATALOGUE DE PIECES DETACHEES**

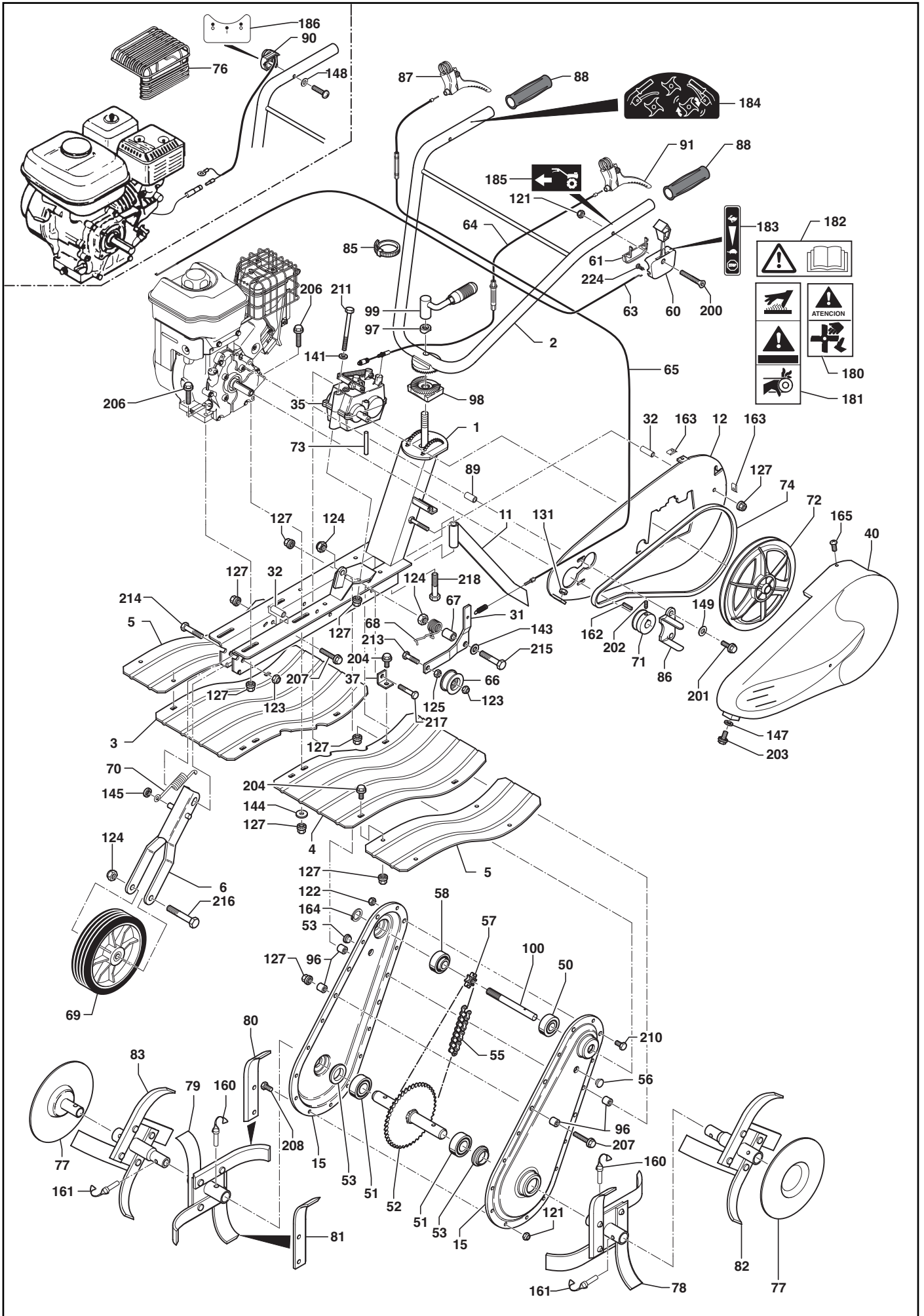

Rep N°	Réf./Ref.		Désignation	Description	Qté Qty
	3001000001	11302500	Carter complet boulonner (noir)	Complete casing, bolt-together (Black)	
1	3002081402	11538101	Châssis (Jaune 5283)	Chassis (Yellow 5283)	1
	3002080502	11528101	Châssis (Gris 8120)	Chassis (Grey 8120)	
	3002080902	11533101	Châssis (Gris 9006)	Chassis (Grey 9006)	
	3002081302	11527101	Châssis (Rouge 3002)	Chassis (Red 3002)	
	3002082101	11536101	Châssis (Vert 7475)	Chassis (Green 7475)	
	3002081901	11537101	Châssis (vert 6018)	Chassis (Green 6018)	
2	3002000304	11440103	Guidon (Noir)	Handlebars (Black)	1
	3002000504	11501103	Guidon (Gris 8120)	Handlebars (Grey 8120)	
3	3002081404	11538118	Tôle protection droit (Jaune 5283)	Right protective cover (Yellow 5283)	1
	3002080504	11528118	Tôle protection droit (Gris 8120)	Right protective cover (Grey 8120)	
	3002080904	11530118	Tôle protection droit (Gris 9006)	Right protective cover (Grey 9006)	
	3002081305	11529118	Tôle protection droit (Rouge 3002)	Right protective cover (Red 3002)	
	3002082104	11536118	Tôle protection droit (Vert 7475)	Right protective cover (Green 7475)	
	3002081903	11537118	Tôle protection droit (Vert 6018)	Right protective cover (Green 6018)	
4	3002081405	11538119	Tôle protection gauche (Jaune 5283)	Left protective cover (Yellow 5283)	1
	3002080505	11528119	Tôle protection gauche (Gris 8120)	Left protective cover (Grey 8120)	
	3002080905	11530119	Tôle protection gauche (Gris 9006)	Left protective cover (Grey 9006)	
	3002081306	11529119	Tôle protection gauche (Rouge 3002)	Left protective cover (Red 3002)	
	3002082105	11536119	Tôle protection gauche (Vert 7475)	Left protective cover (Green 7475)	
	3002081904	11537119	Tôle protection gauche (vert 6018)	Left protective cover (Green 6018)	
5	3002081403	11538117	Extension tôle protection (Jaune 5283)	Protective cover guard extension (Yellow 5283)	2
	3002080503	11528117	Extension tôle protection (Gris 8120)	Protective cover guard extension (Grey 8120)	
	3002080903	11530117	Extension tôle protection (Gris 9006)	Protective cover guard extension (Grey 9006)	
	3002081304	11529117	Extension tôle protection (Rouge 3002)	Protective cover guard extension (Red 3002)	
	3002082103	11536117	Extension tôle protection (Vert 7475)	Protective cover guard extension (Green 7475)	
	3002081902	11537117	Extension tôle protection (Vert 6018)	Protective cover guard extension (Green 6018)	
6	3002000308	12601005	Supp. roue transport (Noir)	Front wheel bracket (Black)	1
11	3002000302	12611011	Éperon (Noir)	Key (Black)	1
12	0340010060		Cache int capot bombée M.av. (Noir)	Forward gear rounded belt cover (black)	1
	0340010064		Cache int capot bombée M.arr. (Noir)	Reverse rounded belt cover (black)	1
15	3002000307	11302130	Joue carter boulonner	Transmission housing	2
31	3002000104	11701140	Levier embrayage	Clutch lever	1
32	0302020015	11301145	Entretoise châssis	Spacer	2
33	3002000101	11526135	Arbre roue double	Double wheel shaft	1
34	3002000103	11526145	Entretoise roue double	Spacer	1
35	0306040001	57720996	Réducteur M. ar. mécanique	Reversing gearbox	1
37	3002080101	11529145	Patte de fixation tôle	Holder	2
40	0341000018	15802	Capot courroie bombé (Noir)	Rounded belt cowl (Black)	1
		15803	Capot courroie bombé (Jaune)	Rounded belt cowl (Yellow)	
	0340010061	15804	Capot courroie bombé (Bleu)	Rounded belt cowl (Blue)	
	0341000016	15808	Capot courroie bombé (Rouge)	Rounded belt cowl (Red)	
50	0306010024		Roulement	Ball-race	1
51	0306010020	12542	Roulement	Ball-race	2
52	0306050010	15038	Arbre de travail	Blade shaft	1
53	0341000059	46097	Joint de carter	Joint	2
55	0306020005	13292	Chaîne	Chain	1
56	0341000014	12793	Bouchon	Grease cap	2
57	0306050016	13372	Pignon 8 dts	Cogwheel	1
58	0306010016	12551	Roulement épaulé	Shouldered Ball-race	1
60	0307020007	64948	Manette gaz	Accelerator lever	1
61	0307020001	62754	Cache manette	Accelerator lever housing	1
63	0308040008	13839a	Câble gaz (B.S. 5,5Hp)	Throttle cable (B.S. 5,5Hp)	1
	0308040004	13130b	Câble gaz (GX 160))	Throttle cable (GX 160))	
	0308040003	13134a	Câble gaz (EX)	Throttle cable (EX)	
	0308040005	13826b	Câble gaz (GC)	Throttle cable (GC)	
64	0308010005		Câble inversion vitesse	Reverse gear cable	1
65	0308020043		Câble embrayage	Clutch cable	1
66	0341000003	12162	Galet embrayage	Runner	1
67	0302020019	16034	Entretoise levier embrayage	Spacer	1
68	0305020005	65133	Ressort embrayage	Spring	1
69	0309000013	14090	Roue avant	Front wheel	1
70	0305010002	65026	Ressort roue transport	Spring	1
71	0306060005	15415	Poulie moteur M. av-M. ar. arbre Ø19,05	Motor pulley Forward/Reverse gear (Shaft Ø19,05)	1
	0306060004	15177a	Poulie moteur M. av. arbre Ø19,05	Motor pulley Forward gear (Shaft Ø19,05)	
72	0341000007	14135	Poulie transmission	Transmission pulley	1
73	0302010021	15098	Axe fixation poulie	Pulley shaft	1
74	0306030024	13609	Courroie M. av-M. ar.	Forward drive belt	1
	0306030032	13600	Courroie M. av	Forward gear belt	
76	0330012003	14814	Grille échappement (GX 160)	Exhaust grill (GX 160)	1
77	0320010001	55102	Disque	Disk	2
78	0320010022	55201	Étoile départ double 40x4 G	Twin rotating blades 40x4 L	1
	0320010014	55098	Étoile départ simple 40x4 G	Simple rotating blades 40x4 L	
79	0320010021	55200	Étoile départ double 40x4 D	Twin rotating blades 40x4 R	1
	0320010013	55097	Étoile départ simple 40x4 D	Simple rotating blades 40x4 R	
80	0001000021	81907	Couteau gauche	Blade, LH	
81	0001000020	81906	Couteau droit	Blade, RH	
82	0320010016	55150	Étoile addit. dém. gauche	Additional blade assembly, LH	
83	0320010015	55103	Étoile addit. dém. droite	Additional blade assembly, RH	
85	0301060003	13249	Collier	Collar	2
86	0304000035	36189	Guide courroie M. av-M. ar.	Drive-belt guide Forward/Reverse gear	1
	0304000036	36188	Guide courroie M. av	Drive-belt guide Forward gear	
87	0307010020		Levier embr LAB C25	Lever LAB C25	1
88	0341000036	12126	Poignée PVC	Grip	2

Rep N°	Réf./Ref.		Désignation	Description	Qté Qty
89	0302020010	16037	Entretoise D13 d9 Lg 8,5	Spacer D13 d9 Lg 8,5	1
	0302020011	16038	Entretoise D13 d9 Lg 12,5	Spacer D13 d9 Lg 12,5	
	0302020012	16039	Entretoise D13 d9 Lg 15,5	Spacer D13 d9 Lg 15,5	
90	0330012006	13210	Switch arrêt moteur	Switch engine cut-off	1
91	0307010025		Levier LAB C20	Lever LAB C20	1
96	0302020028	16009	Entretoise carter boulonné	Spacer	4
97	0302020037	16023	Entretoise poignée de serrage	Spacer	1
98	0303000007	36006	Pièce intermédiaire	Filler piece	1
99	0300801401	15431	Poignée de serrage	Handlebar tightening lever	1
100	0306050001	15029	Arbre M. av	Shaft forward gear	1
121	0300210602	11482	Écrou frein M6 Z	Blocking nut M6 Z	
123	0300211001	11485	Écrou frein M10 Z	Blocking nut M10 Z	
124	0300211201	11486	Écrou frein M12 Z	Blocking nut M12 Z	
125	0300201002	11429	Écrou H M10 Z	Nut H M10 Z	
126	0300260601	11518	Écrou H M6 Z embase crantée	Nut H M6 Z, notched shoulder	
127	0300260801	11519	Écrou H M8 Z embase crantée	Nut H M8 Z, notched shoulder	
131	0300200601	11425	Écrou H M6 Z	Nut H M6 Z	
141	0300400802	11616	Rondelle 8 Z	Washer 8 Z	
143	0300401201	11635	Rondelle 12x27x2,5 Z	Washer 12x27x2,5 Z	
144	0300410901	11619	Rondelle 9x20x3 Z	Washer 9x20x3 Z	
145	0300461001	11818	Rondelle starlock 12	Starlock washer 12	
146	0300461201	11826	Rondelle starlock 12	Starlock washer 12	
147	0300400801	11617	Rondelle 8x30x1,5 Z	Washer 8x30x1,5 Z	
148	0300400301	11611	Rondelle 3,2x10x1 Z	Washer 3,2x10x1 Z	
149	0300430801	11699	Rondelle contact 8	Contact washer 8	
160	0301010011	55078	Goupille clips Ø10	Clip pin, 10mm diameter	
161	0301010010	55079	Goupille clips Ø8	Clip pin, 8mm diameter	
162	0301040001	12979	Clavette arbre Ø19,05	Key (Shaft Ø19,05)	
163	0301050001	11495	Clips 4,2	Spire nuts 4,2	
164	0301070001	12855	Circlips	Circlips	
165	0300080405	11135	Vis Tôle 4,2	Cover bolt 4,2	
180	0503000057	21259	Étiq. "Danger fraises"	Label: "Danger - rotating blades"	
181	0503000056	21258	Étiq. "Sécurité"	Safety label	
182		21260	Étiq. "Lire manuel"	Label: "Read the manual"	
183	0503000045	64668	Étiquette de gaz + arrêt moteur	Label: Accelerator lever + engine cut-off	
184	0503000029	62831a	Étiquette embrayage mécanique	Label: Clutch lever	
185	0503000032	62830	Étiq. "inversion de vitesse "	Label: Forward and reverse gears	
186	0503000015	14678b	Étiq. "Arrêt moteur"	Label: "engine cut-off "	
200	0300030603	11176	Vis TF Hc M6x45 Z	Screw TF Hc M6x45 Z	
201	0300060503	11116	Vis 5/16 TH24 UNF lg 25 emb crantée	Screw 5/16 TH24 UNF lg 25, notched shoulder	
	0300060502	11117	Vis 5/16 TH24 UNF lg 32	Screw 5/16 TH24 UNF lg 32	
	0300010838		Vis HM8x25 Z embase crantée	Screw HM8x25 Z, notched shoulder	
202	0300040801	11085	Vis St Hc M8x16 N	Screw St Hc M8x16 N	
203	0300010609	11250	Vis H M6x16 Z embase crantée	Screw H M6x16 Z, notched shoulder	
204	0300010815	11260	Vis H M8x16 Z embase crantée	Screw H M8x16 Z, notched shoulder	
206	0300010817	11265	Vis H M8x40 Z embase crantée moteur GC/Briggs/Tecum	Screw H M8x40 Z, notched shoulder motor GC/Briggs/Tecum	
	0300010818	11266	Vis H M8x45 Z embase crantée moteur Robin	Screw H M8x45 Z, notched shoulder motor Robin	
207	0300010820	11267	Vis H M8x50 Z embase crantée	Screw H M8x50 Z, notched shoulder	
208	0300010608	10760	Vis H M6x12	Screw H M6x12	
210	0300010801	10766	Vis H M8x16	Screw H M8x16	
211	0300010804	10794	Vis H M8x110 Z	Screw H M8x110 Z	
213	0300011003	10810	Vis H M10x35 Z	Screw H M10x35 Z	
214	0300011007	10834	Vis H M10x55 Z	Screw H M10x55 Z	
215	0300011207	10859	Vis H M12x60 Z	Screw H M12x60 Z	
216	0300011206	10863	Vis H M12x80 Z	Screw H M12x80 Z	
217	0300010811	10781	Vis H M8x60 Z	Screw H M8x60 Z	
218	0300011401	10899	Vis H M14x90 Z	Screw H M14x90 Z	
224	0300090301	11502	Vis	Screw	