

DUMPER DH-15 , DH-160



Dibujo N 37 Design N Dessin N		CALCOMANÍAS DECALS DECALCOMANIES COMUNES						Pag. 138
Pos.	Ref.	Denominación Description Designation	Can. Qty. Quant.	Sustitu. Por Subs. By Susbs. Pat	Can. Qty. Quant.	Sustituye a. Subs. For Susbs.â	Can. Qty. Quant.	Observaciones Remarks Observations
1	809136	Calcomanía de velocidades Speed decal Decalcomanie de vitesses	1					
2	811316	Calcomanía Agrimac-Agria Decal Decalcomanie	1					
3	811317	Calcomanía Agrimac-Agria Decal Decalcomanie	1					
4	811318	Calcomanía Agrimac-Agria Decal Decalcomanie	1					
5	811320	Calcomanía lateral Decal Decalcomanie	2					
6	811321	Calcomanía motor arranque Starting engine decal Decal. moteur de demarrage	1					
7	811322	Calcomanía freno de mano Brake and decal Decal. de frein de main	1					
8	806346	Calcomanía adelante-atrás Front-rear decal Decalcomanie avant-arriere	1					
9	806348	Calcomanía nivel de aceite Oil decal Decalcomanie d'huile	1					
10	806355	Placa de características Characteristic plate Plaque d'characteristique	1					
11	806360	Calcomanía de combustible Fuel decal Decalcomanie d'fuel	1					
12	806349	Calcomanía de advertencia Decal Decalcomanie	1					
13	807013	Calcomanía de seguridad Safety decal Decalcomanie de securite	1					
14	9TH029	Calcomanía aceite hidrául. Oil decal Decalcomanie d'huile	1					
15	810267	Calcomanía llave arranque Starting decal Decalcomanie de demarrage	1					
16	811885	Manual de instrucciones Instructions manual Manuel d'instructions	1					

DUMPER DH-15 , DH-160



Dibujo N
Design N 38
Dessin N

CALCOMANÍAS DECALS DECALCOMANIES DH-15

Pag.
140

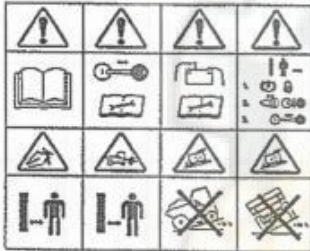
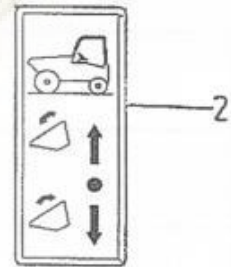

DUMPER DH-15 , DH-160



CALCOMANÍAS DECALS DECALCOMANIES DH-15 DA

Pag.
142

Dibujo N
Design N 39
Dessin N

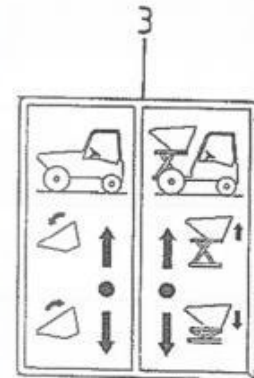

DUMPER DH-15 , DH-160



Dibujo N
Design N **40**
Dessin N

CALCOMANÍAS
DECALS
DECALCOMANIES
DH-15 DE

Pag.
144

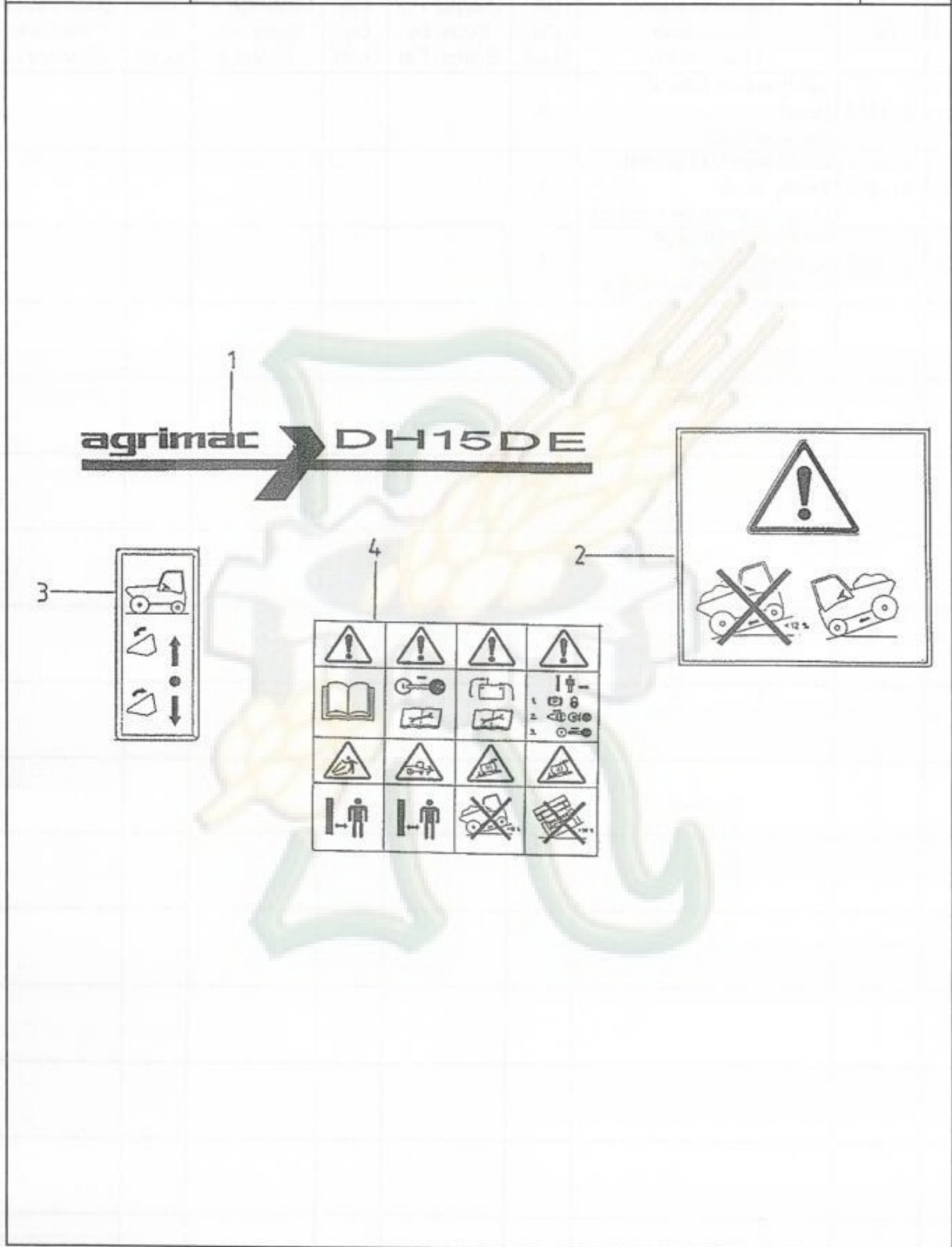

DUMPER DH-15 , DH-160



Dibujo N
Design N 41
Dessin N

CALCOMANÍAS
DECALS
DECALCOMANIES
DH-15 DG

Pag.
146

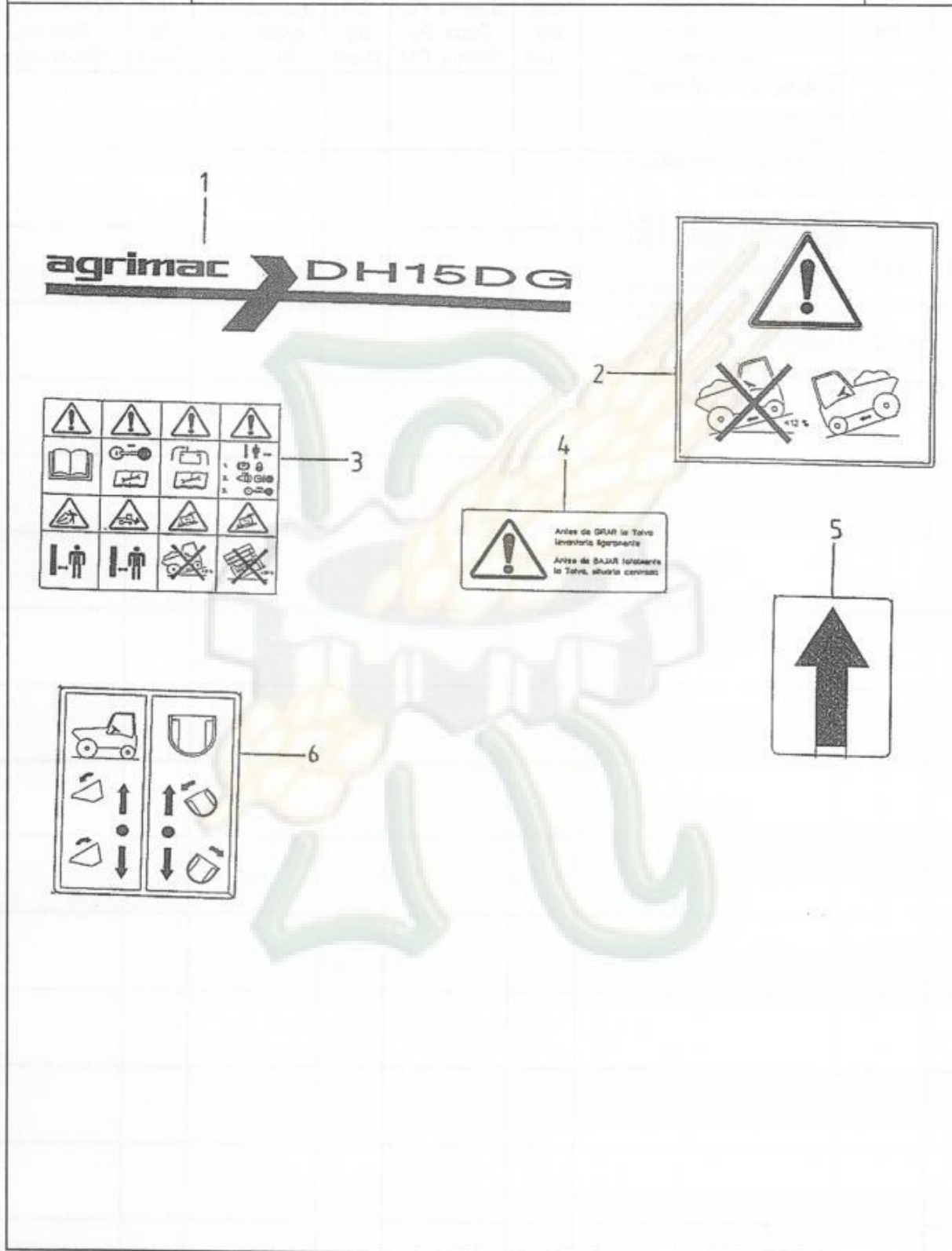

DUMPER DH-15 , DH-160



Dibujo N
Design N **42**
Dessin N

CALCOMANÍAS
DECALS
DECALCOMANIES
DH-15 HG

Pag.
148

agrimac  **DH160HG**

1

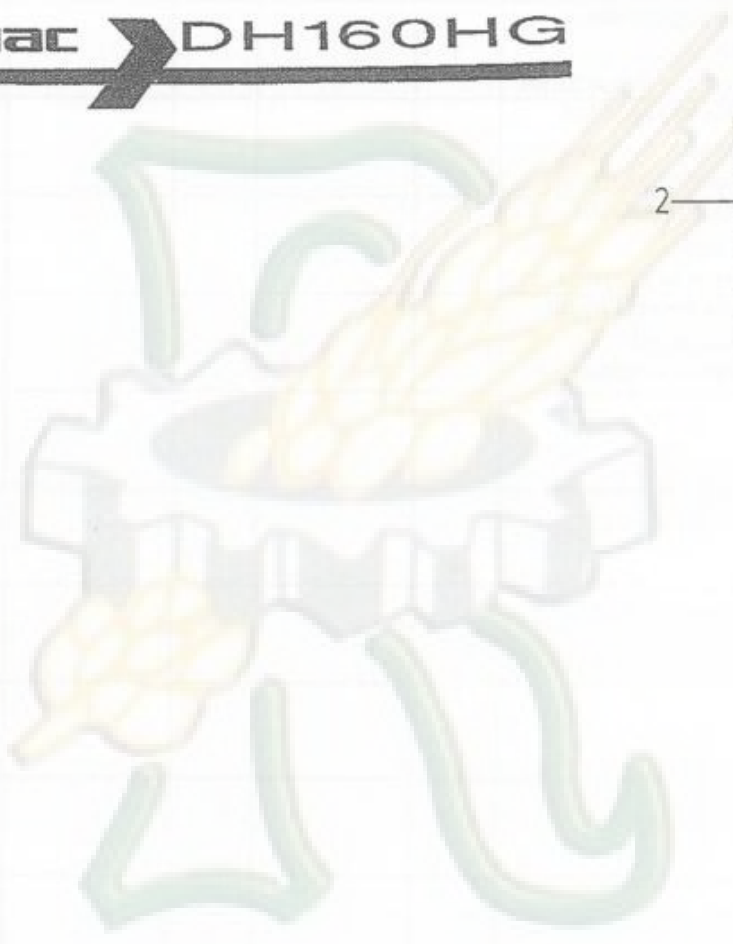

2

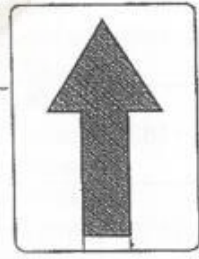

DUMPER DH-15 , DH-160



CALCOMANÍAS DECALS DECALCOMANIES DH-15 P

Pag.
150

Dibujo N
Design N 43
Dessin N

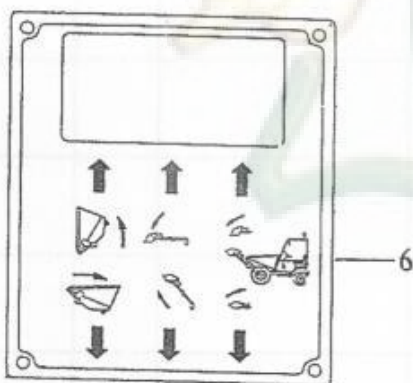
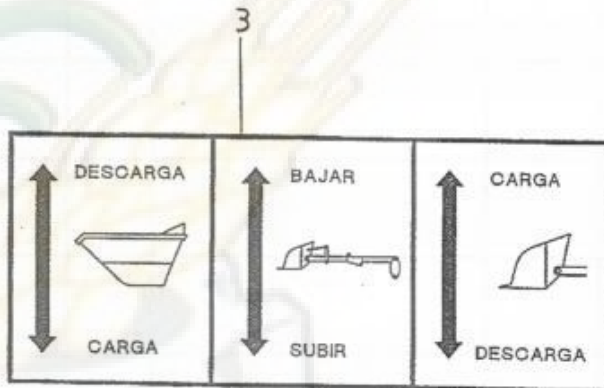

DUMPER DH-15 , DH-160



SISTEMAS MODIFICADOS MODIFIED SYSTEMS SYSTÉMES MODIFIER



DUMPER DH-15 , DH-160



SISTEMA DE PEDALES PEDAL SYSTEM SYSTÈME DE PEDALE

Pag.
2

Dibujo N 1
Design N
Dessin N

Pos.	Ref.	Denominación Description Designation	Can. Qty. Quant.	Sustitu. Por Subs. By Susbs. Pat	Can. Qty. Quant.	Sustituye a. Subs. For Susbs.â	Can. Qty. Quant.	Observaciones Remarks Observations
1	806430	Tornillo rasca-chapa Screw M-4'5 x 9'5 Vis	4					
2	851411	Tapa cable de embrague Cover Couvercle	1					
3	811137	Cable de embrague Clutchin cable Câble de embrayage	1					
4	006650	Tuerca autoblocante Nut M-8 Ecrou	1					
5	041431	Cabecilla guía de cable Cable guide Guide câble	1					
6	005890	Tuerca Nut M-10 Ecrou	1					
7	126540	Cabecilla guía de cable Cable guide Guide câble	1					
8	126760	Muelle de fijación Holding spring Ressort	1					
9	880520	Pedal de embrague Clutch pedal Pédale d'embrayage	1					
10	8TM338	Goma de pedal Pedal rubber Gomme d'pédale	2					
11	804977	Interruptor de embrague Interrupting Interrupteur	1					
12	007860	Arandela plana Washer Rondelle	1					
13	006380	Contratuerca Nut M-14 x 1'5 Ecrou	1					
14	850038	Soporte de pedales Pedals support Support d'pedale	1					
15	874602	Tornillo hexagonal Screw M-8 x 20 Vis	4					
16	9TH357	Casquillo de giro Bush Bague	4					

DUMPER DH-15 , DH-160



Dibujo N **1**
Design N
Dessin N

SISTEMA DE PEDALES PEDAL SYSTEM SYSTÈME DE PEDALE

Pag.
3

Pos.	Ref.	Denominación Description Designation	Can. Qty. Quant.	Sustitu. Por Subs. By Susbs. Pat	Can. Qty. Quant.	Sustituye a. Subs. For Susbs.â	Can. Qty. Quant.	Observaciones Remarks Observations
17	007890	Arandela Washer Ø 21 x 37 Rondelle	2					
18	850374	Casquillo separador Bush Bague	1					
19	850039	Eje de pedales Pedal shaft Arbre de pédale	1					
20	005951	Tuerca hexagonal Nut M-8 Ecrou	4					
21	809325	Espárrago Stud M-8 x 35 Goujon	2					
22	850040	Muelle de pedales Spring Ressort	2					
23	850082	Varilla empuje bomba Rod Tirant	1					
24	880334	Pedal de freno Brake pedal Pedale de freinage	1					
25	810001	Bombín de freno Pump of brake Pompe d'frein	1					
26	009080	Arandela junta Washer Rondelle	1					
27	806677	Tornillo tapón Plug screw Vis bouchon	1					
28	809415	Tornillo hexagonal Screw M-8 x 25 Vis	2					
29	9TH411	Depósito líquido de freno Tank Reservoir	1					
30	806731	Abrazadera Clamp 9-14 Bride	2					
31	806732	Tubo de depósito a bombín Pipe Tuyau	2					
33	811131	Latiguillo de freno Pipe Tuyau	2					

DUMPER DH-15 , DH-160



SISTEMA DE PEDALES PEDAL SYSTEM SYSTÈME DE PEDALE

Pag.
4

Dibujo N 1
Design N
Dessin N

Pos.	Ref.	Denominación Description Designation	Can. Qty. Quant.	Sustitu. Por Subs. By Susbs. Pat	Can. Qty. Quant.	Sustituye a. Subs. For Susbs.â	Can. Qty. Quant.	Observaciones Remarks Observations
34	809217	Tubo de freno Pipe Tuyau	1					
35	851909	Brida Clamp Bride	1					
36	807130	Tornillo hexagonal Screw M-8 x 16 Vis	1					
37	014600	Pasador de aletas Locking clamp Broche d'attelage	1					
38	007840	Arandela plana Washer Ø 10'5 Rondelle	1					
39	806342	Chapa soporte de muelle Support plate Plaque support	1					
40	806343	Muelle recuperador Spring Ressort	1					
41	9TH303	Pedal de acelerador Accelerator pedal Pédale d'accelerateur	1					
42	001120	Tornillo hexagonal Screw M-6 x 16 Vis	3					
43	007801	Arandela plana Washer Ø 6'4 Rondelle	3					
44	005930	Tuerca hexagonal Nut M-6 Ecrou	3					
45	851608	Tope cable de acelerador Butt cable Sabot câble	1					
46	8TM102	Cable de acelerador Accelerator cable Câble de accelerateur	1					
47	811914	Mando de stop completo Stop control Commande de stop	1					
48	8TM017	Prisionero de cable Stud bolt Goujon	1					
49	851918	Tope cable de acelerador Butt cable Sabot câble	1					

DUMPER DH-15 , DH-160



Dibujo N
Design N 2
Dessin N

CHASSIS CHASSIS CHASSIS

Hasta maqu.
Up to mach. 155238
Jusqu'a mach.

Pag.

6

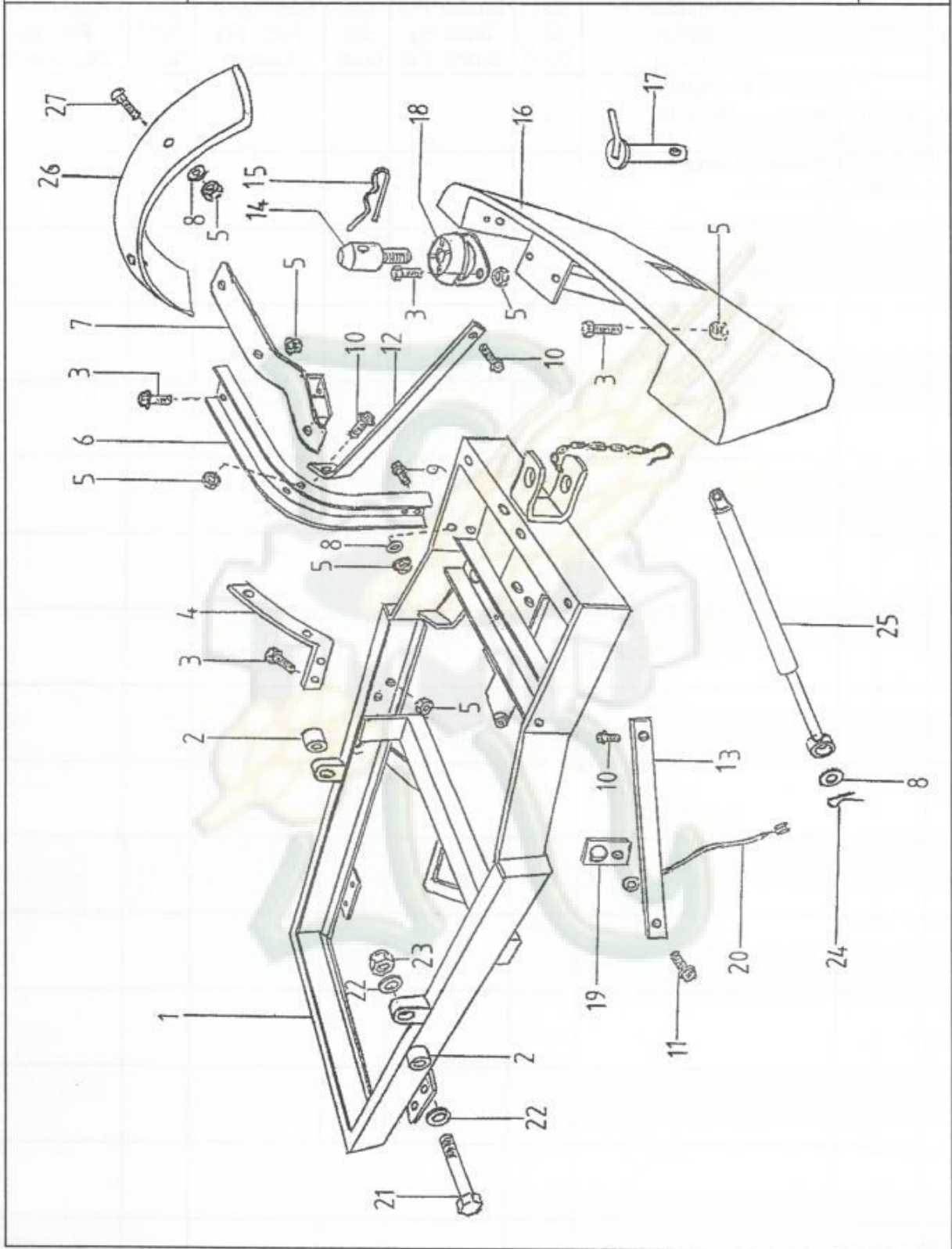

DUMPER DH-15 , DH-160



Dibujo N **2**
Design N
Dessin N

CHASIS CHASSIS CHASSIS

Pag.
7

Pos.	Ref.	Denominación Description Designation	Can. Qty. Quant.	Sustitu. Por Subs. By Susbs. Pat	Can. Qty. Quant.	Sustituye a. Subs. For Susbs.â	Can. Qty. Quant.	Observaciones Remarks Observations
1	880553	Chasis Chassis Chassis	1					
2	809997	Casquillo amortiguador Shock absorber Amortisseur	2					
3	874608	Tornillo hexagonal Screw M-8 x 25 Vis	8					
4	851527	Soporte de guardabarros Fender support Support de aile	1					
5	875101	Tuerca hexagonal Nut M-8 Ecrou	14					
6	8511526	Soporte lateral derecho Right support Support droite	1					
7	880571	Apoyo guardabarros dcho. Right support fender Support de aile droite	1					
8	761520	Arandela plana Washer 8'4 x 25 Rondelle	8					
9	874603	Tornillo hexagonal Screw M-8 x 30 Vis	2					
10	874602	Tornillo hexagonal Screw M-8 x 20 Vis	3					
11	874603	Tornillo hexagonal Screw M-8 x 30 Vis	1					
12	851523	Tirante derecho Right tie rod Tirant droite	1					
13	851524	Tirante izquierdo Left tie rod Tirant gauche	1					
14	851525	Centrador de cabina Protection cab guide Guide de cabine	1					
15	810976	Pasador Pin R Ø 5 Goupille	1					
16	880569	Faldón trasero Slope of a roof rear Jupe arrière	1					

DUMPER DH-15 , DH-160



CHASIS CHASSIS CHASSIS

Pag.
8

Dibujo N 2
Design N
Dessin N

Pos.	Ref.	Denominación Description Designation	Can. Qty. Quant.	Sustitu. Por Subs. By Susbs. Pat	Can. Qty. Quant.	Sustituye a. Subs. For Susbs.â	Can. Qty. Quant.	Observaciones Remarks Observations
17	274446	Bulón de enganche Locking plug Cheville de blocage	1					
18	8TM103	Soporte elástico Absorbing support Support amortisseur	1					
19	851340	Soporte avisador m.a. Warning support Support amortisseur	1					
20	805017	Cable de masa Ground cable Câble d'masse	1					
21	806287	Tornillo hexagonal Screw M-14 x 80 Vis	2					
22	007860	Arandela plana Washer Ø 15 x 28 Rondelle	4					
23	006680	Tuerca autoblocante Nut M-14 Ecrou	2					
24	014600	Pasador de horquilla Pin Ø 3 Goupille	2					
25	811425	Resorte de gas Absorbing Amortisseur	1					
26	811134	Guardabarros Fender Aile	1					
27	811222	Tornillo gota-sebo Screw M-8 x 25 Vis	2					

DUMPER DH-15 , DH-160



Dibujo N
Design N 3
Dessin N

CARROCERÍA DE CABINA TRUCK BODY CAB CARROSSERIE D'CABINE

Hasta maq.
Up to mach. 155238
Jusqu'a mach.

Pag.

9

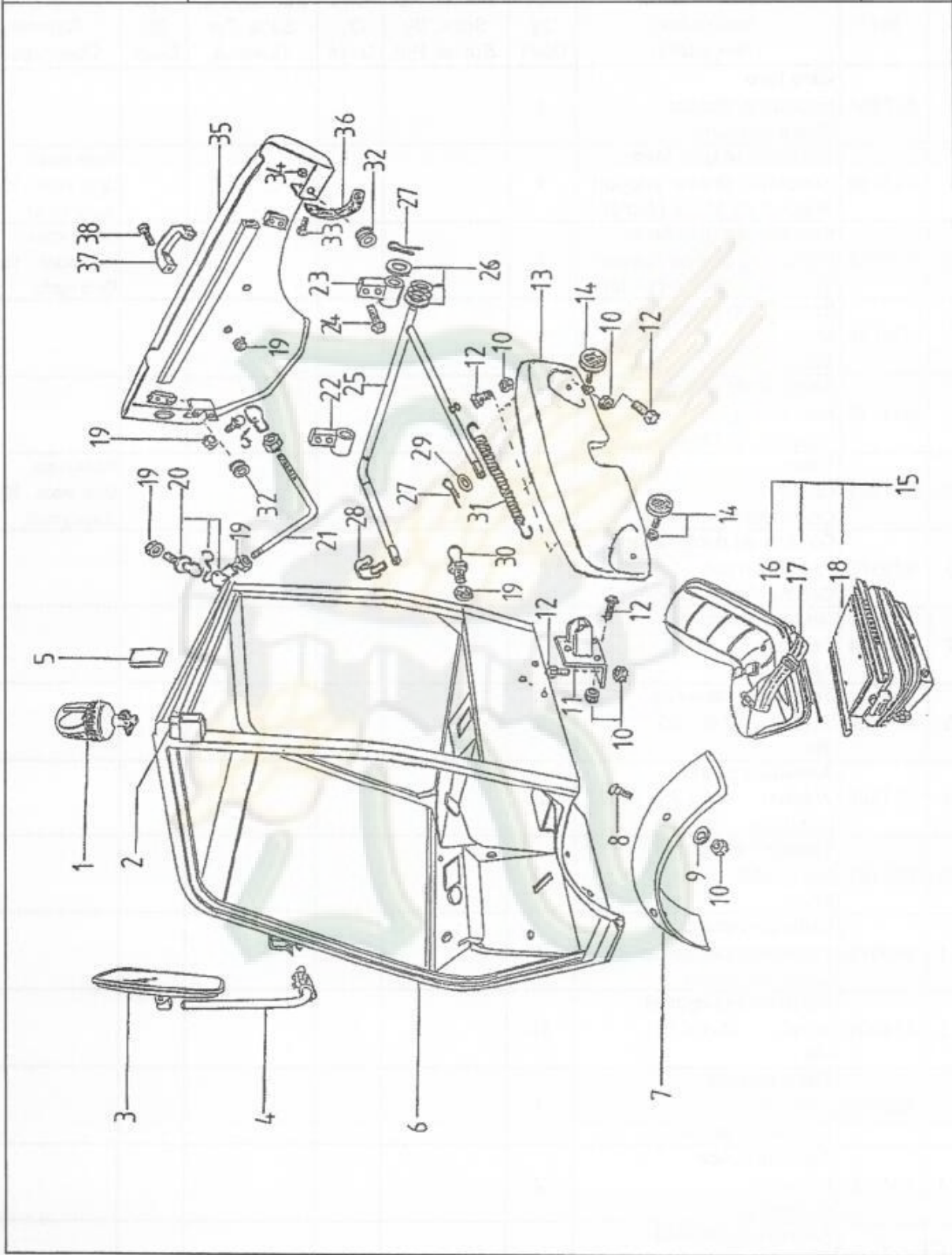

DUMPER DH-15 , DH-160



CARROCERÍA DE CABINA TRUCK BODY CAB CARROSSERIE D'CABINE

Pag.
10

Dibujo N **3**
Design N
Dessin N

Pos.	Ref.	Denominación Description Designation	Can. Qty. Quant.	Sustitu. Por Subs. By Susbs. Pat	Can. Qty. Quant.	Sustituye a. Subs. For Susbs.â	Can. Qty. Quant.	Observaciones Remarks Observations
1	807584	Giro faro Hedolamp drawer Phare pivotant	1					
2	807586	Soporte de giro faro Hedolamp drawer support Support de phare pivotant	1					Hasta maqu. Up to mach. 10.7.03 Jusqu'a mach
2a	810183	Soporte de giro faro Hedolamp drawer support Support de phare pivotant	1					Desde maqu. From mach. 10.7.03 De la mach.
3	809737	Espejo retrovisor Mirror Miroir	1					
4	809736	Soporte de espejo Mirror support Support de miroir	1					
5	811221	Tapa Cover Couvercle	1					Hasta maqu. Up to mach. 10.7.03 Jusqu'a mach
6	880573	Cabina de protección Protection cab Cabine de protection	1					
7	811134	Guardabarros Fender Aile	1					
8	811222	Tornillo gota-sebo Screw M-8 x 25 Vis	2					
9	761520	Arandela plana Washer 8'4 x 25 Rondelle	2					
10	875101	Tuerca hexagonal Nut M-8 Ecrou	12					
11	880579	Guía de centrador Protection cab guide Guide de cabine	1					
12	874601	Tornillo hexagonal Screw M-8 x 15 Vis	10					
13	880606	Tapa trasera Rear cover Couvercle arrière	1					
14	764000	Catadióptico Reflector Réflecteur	2					
15	811315	Asiento completo Compleat seat Seige complete	1					

DUMPER DH-15 , DH-160



Dibujo N **3**
Design N
Dessin N

CARROCERÍA DE CABINA TRUCK BODY CAB CARROSSERIE D'CABINE

Pag.
11

Pos.	Ref.	Denominación Description Designation	Can. Qty. Quant.	Sustitu. Por Subs. By Susbs. Pat	Can. Qty. Quant.	Sustituye a. Subs. For Susbs.â	Can. Qty. Quant.	Observaciones Remarks Observations
16	806305	Asiento Seat Seige	1					
17	8TM919	Cinturón de seguridad Safety belt Ceinture de sûreté	1					
18	851536	Soporte de asiento Seat support Support de seige	1					
19	005951	Tuerca hexagonal Nut M-8 Ecrou	1					
20	809106	Articulación completa Ball and socket joint Joint à rotule	2					
21	851633	Tirante Tie rod Tirant	1					
22	880608	Bisagra delantera Front hinge Charnière avant	1					
23	880609	Bisagra trasera Rear hinge Charnière arriere	1					
24	001080	Tornillo hexagonal Screw M-6 x 12 Vis	4					
25	880876	Marco bisagra Hinge franie Corniche de charniere	1					
26	007198	Arandela plana Washer Ø 12 x 24 Rondelle	4					
27	014600	Pasador de horquilla Split pin Goupille fendue	2					
28	809836	Pasador de enganche Coupling pin Goupille de securite	1					
29	007840	Arandela plana Washer 10'5 Rondelle	1					
30	806617	Bulón de anclaje Pin Boulon	2					
31	850040	Muelle Spring Ressort	1					

DUMPER DH-15 , DH-160



Dibujo N
Design N 4
Dessin N

RUEDAS
WHEELS
ROUES

Pag.
13

